

# Pin Inserter

For Small Part Assembly

**Productivity Through  
Mechanization and  
Automation**

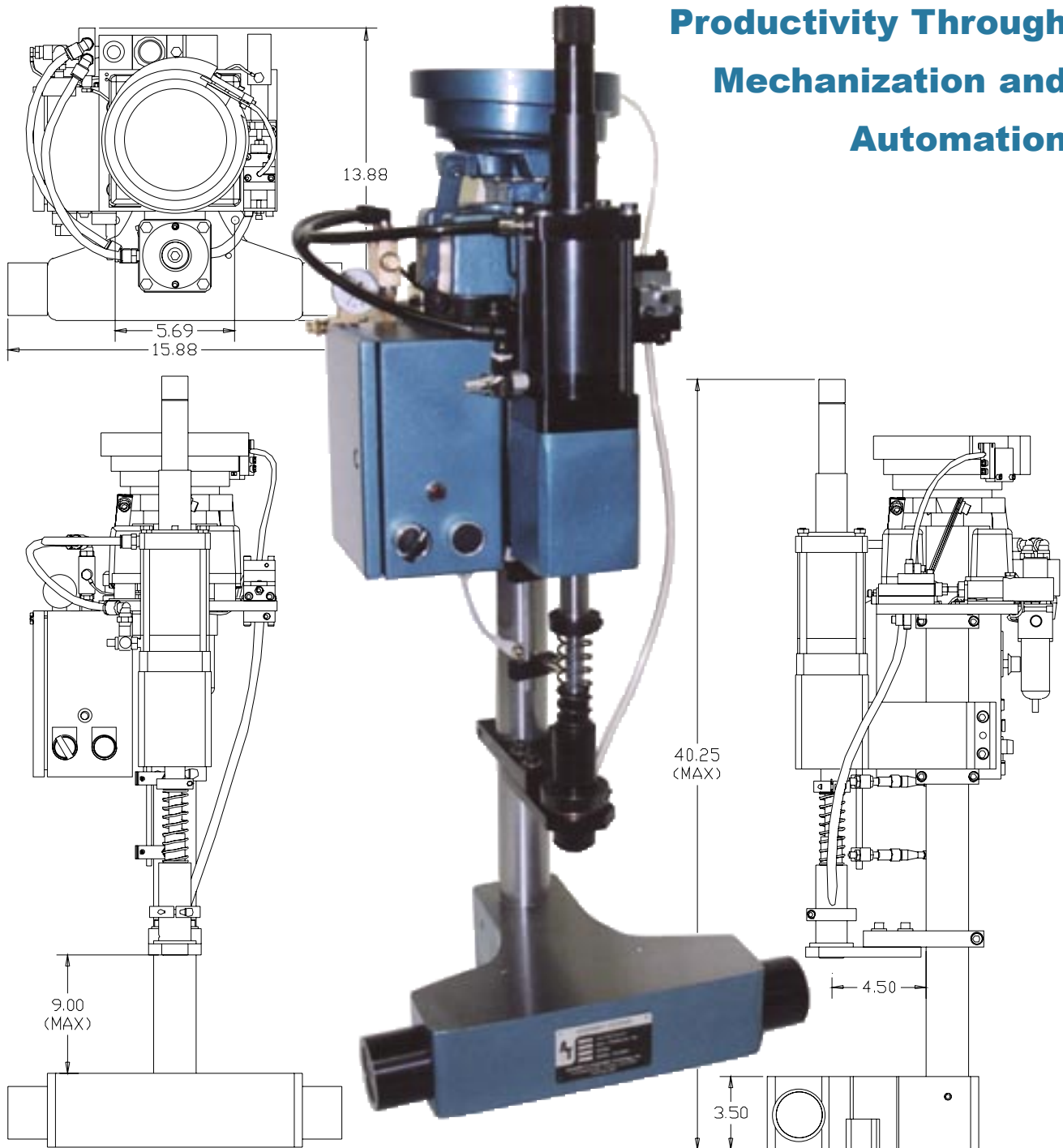

**ASSEMBLY & AUTOMATION TECHNOLOGY, INC.**

# PIN INSERTER SPECIFICATIONS

**PI-M**

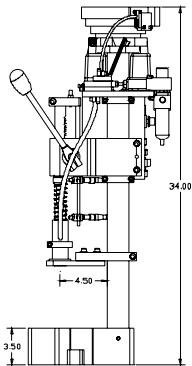
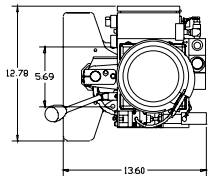
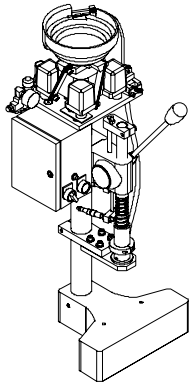

**PI-700**

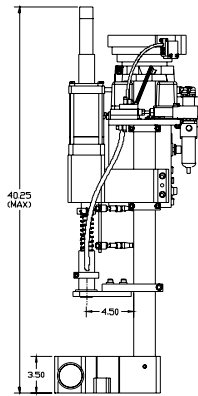
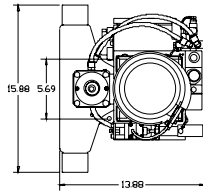
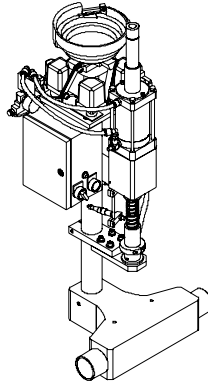

**PI-1400**

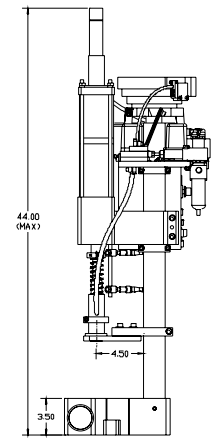
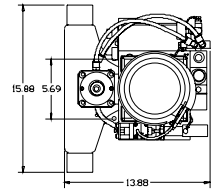
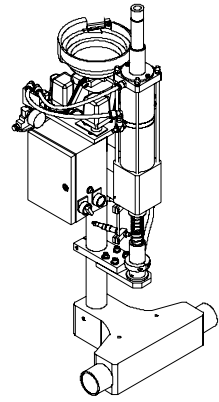

	<b>MODEL PI-M</b>	<b>MODEL PI-700</b>	<b>MODEL PI-1400</b>
Pin cross section length (inches)	.062 - .250	.062 - .250	.062 - .250
Pin length (inches)	.250 - 1.250	.250 - 1.250	.250 - 1.250
Press force at 100 PSI	350	700	1400
Adjustable stroke (inches)	2-3	2-3	2-3
Throat depth (inches)	4.5	4.5	4.5
Maximum shut height (inches)	7.0	7.0	7.0
Maximum cycle rate (parts/min)	NA	40	40
Tooling holes in base	(2) 5/16 - 18x5	(2) 5/16 - 18x5	(2) 5/16 - 18x5
Electrical requirements (Volts/Hz)	115/60	115/60	115/60
Pneumatic requirements (PSI)	30 - 100	30 - 100	30 - 100
Weight (lbs)	112	125	129



## INSERTER FEATURES



**PI-M**

- Hand lever mounts to a splined shaft to allow for handle location adjustment.
- Manual arbor allows for tactile sensing while inserting.



**PI-700**



**PI-1400**

- Low force (1 oz.) dual palm non-tie down/non-repeat pneumatic safety actuators (foot switch optional).
- Adaptable to fully automatic rotary, linear and x-y systems.
- Double acting cylinder with low air consumption.
- Flow control for stroke velocity adjustment.

- Increase productivity up to 6 times over manual methods.
- Part gauging features for both the cross section and for long parts.
- Hardened tooling for long life.
- Programmable Logic Controller (PLC) for reliability.
- Precision-ground cast iron base with bench-top mounting.
- Precise repeatable stroke within 0.001 inch.
- Infinite stroke adjustment within range.
- Retracting head for easy part load and unload.
- Non-rotating ram.
- Filter/regulator/lubricator (FRL) with pressure gauge.
- Custom slide/nest tooling available.

## APPLICATIONS

- Automotive
- Plastics
- Electro-Mechanical
- Appliance
- Lighting
- Medical
- Toys/Games
- Mechanical
- Electronics

## TECHNICAL SUPPORT

Assembly & Automation Technology will utilize its decades of experience to provide sample part evaluation, application engineering assistance, and custom tooling design.

**Please call or send your sample parts today for a free quotation.**

## OTHER PRODUCTS

### STANDARD PNEUMATIC STAKERS & PRESS-STAKERS



**STAKER**  
S-5000 S-8000

- Pneumatic models from a light tap to 8000 lbs. of impact force.
- Repeatability within .001 inch.
- Rates up to 60 cycles per minute (staker).
- Non-rotating ram optional (staker).
- Low force (1 oz.) dual palm safety actuators with non-tie down, non-repeat control (staker).
- Foot or hand switch with ram position safety interlock (press-staker).
- Filter-regulator-lubricator with pressure gauge.
- Cast iron base with bench-top mounting.



**PRESS-STAKER**  
PS-3000 PS-5000

### STANDARD PNEUMATIC PRESSES



**PRESS**  
P-70

- 200, 700, 1400, 2100 lb. capacity at 100 PSI.
- Cast iron base and head bracket.
- Adjustable, repeatable stroke.
- Non-rotating ram.
- Double acting cylinder.
- Flow control for stroke speed adjustment.
- Low force (1 oz.) dual palm safety actuators with non-tie down, non repeat control.
- Filter / regulator / lubricator with pressure gauge.



**PRESS**  
P-200

### STANDARD AUTOMATIC SCREWDRIVER



**S-250**

- Model S-250 for screws, nuts and threaded parts.
- #3 to 1/4 screw, up to 1" long (standard).
- Precise placement torque and depth.
- Easy set up and adjustment.
- Automatic feed.
- Pneumatic operation.
- Built for durability, low maintenance and long life.

### CUSTOM AUTOMATED SYSTEMS



Assembly & Automation Technology, Inc. has been creating innovative solutions for its customers since 1985 by capitalizing on its engineering depth with over 30 years of experience designing and manufacturing over 800 manual, semi and fully automatic assembly machines. This equipment is being used for the following applications: automotive, plastics, electro-mechanical, appliance, lighting, material handling, toy/game, mechanical, packaging, medical and electronics. We have succeeded where others have failed. Challenge us with your application.



## ASSEMBLY & AUTOMATION TECHNOLOGY, INC.

9 Presidential Way Woburn, MA 01801 Phone: 978/692-1801 Fax: 781/935-6333

Web: [www.assemblyandautomationtech.com](http://www.assemblyandautomationtech.com)